

Soundstage One – ShowRig Stage

SAFETY NOTICE

WEATHER MANAGEMENT

Monitoring the wind conditions whilst using the stage is vitally important. A wind monitoring system with a visual display is provided with the stage which shows the current wind speed

Depending on the wind speed, the following actions should be taken. The client and/or stage manager is responsible for monitoring the wind speed. Should Soundstage One staff be on site, they will offer guidance on the best and safest actions to take in any event

Mph	Kmh	Mps	Action
22	35	9.8	Keep a close watch and monitor the wind speed and conditions
35	56	15.6	Installation / removal of the stage may need to be halted Stage roof cannot be raised or lowered. Closely monitor the structure Any loads suspended from the structure may need to be restrained
45	72	20	You are advised to evacuate the stage and the surrounding area. Remain at a safe distance until the wind drops and the all clear is given. Ensure items on stage are removed or restrained

PREVENT THE ACCUMULATION OF SNOW ON THE STAGE ROOF
EVACUATION MUST OCCUR IF SNOW ACCUMULATES TO A DEPTH OF 10cm
THE STAGE SHOULD BE EVACUATED IN THE EVENT OF LIGHTNING STORMS

ANY EQUIPMENT OR ITEMS THAT ARE LEFT ON OR AROUND THE STAGE ARE ENTIRELY AT THE OWNERS RISK

ANY ELECTRICAL EQUIPMENT OR RIGGING EQUIPMENT USED ON THE STAGE SHOULD COMPLY WITH RELEVANT CERTIFICATION, CURRENT TESTING REQUIREMENTS AND BE INSTALLED IN CONJUNCTION WITH RELEVANT GUIDELINES.

CLIMBING ON THE ROOF STRUCTURE IS NOT PERMITTED

WEIGHT LOADINGS

Any equipment suspended from the stage structure or positioned on the stage needs to be within the limits shown below

Installers are required to provide a completion certificate following installation
Any such equipment installation must be approved by Soundstage One prior to the installation commencing

No equipment can be connected onto the stage roof prior to or during elevation or decent

Any branding/banners attached to the stage should be approved by Soundstage One - Only suitable wind permeable material should be used for banners over 4sqm and on PA wings

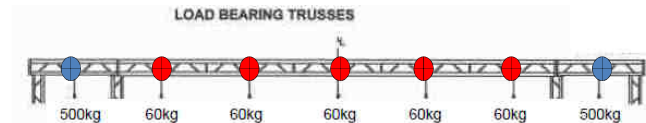

Maximum load of all 3 bearing trusses 900kg
Maximum load per bearing truss 300kg

● Rigging point maximum load 500kg

● Rigging point maximum load 60kg

All loads should be evenly distributed
Stage specifications subject to change without notice E&OE

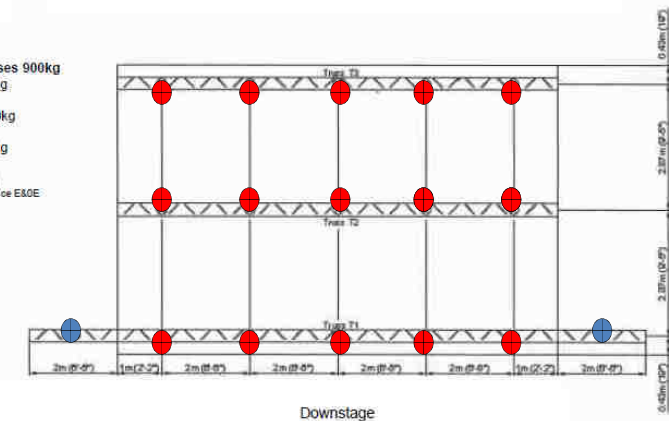

FLOOR LOAD CAPACITY: 500kg/sqm

Soundstage One reserve the right to restrict or prevent access to or have use of the stage and its equipment for safety reasons

A restricted area should be maintained around the stage at all times including during the installation and removal of the structure



BEWARE OF UNPROTECTED EDGES OF THE STAGE FLOOR AND TRIP HAZARDS ON AND AROUND THE STAGE



SOME SURFACES ON AND AROUND THE STAGE MAY BE SLIPPERY WHEN WET

Soundstage One ShowRig II Mobile Stage General Layout, Fittings & SWL (with PA wings) – Plan Elevation

NOT TO SCALE

